

Residence Hall Floor Plans

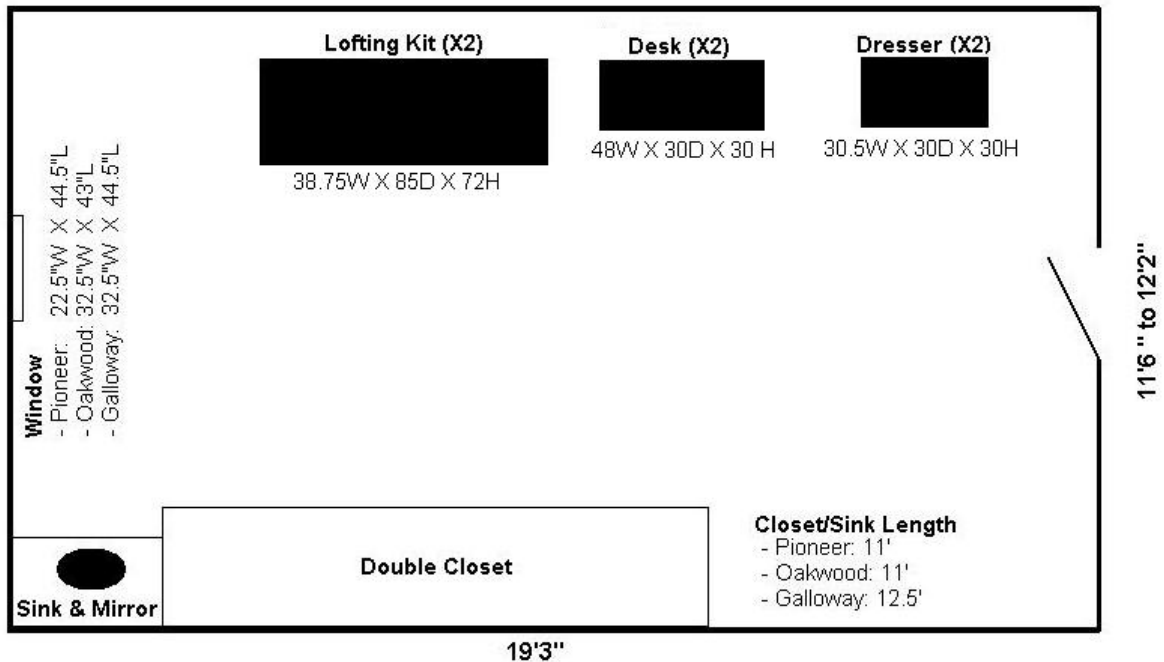

Please note that this is the floor plan for all EVEN numbered rooms. For ODD numbered rooms, the built-ins are located on the opposite side of the diagram.

RESIDENCE HALL OR APARTMENT ITEMS

Some beds on campus use regular twin size sheets and some use long twin sized sheets. We recommend buying sheets that are longer so they will fit both types of mattresses. If you need an extra-long mattress, you can request that from the Administrative Assistant at 4602.

- Other needed dimensions:
 - Closet dimensions = 46 ½" wide x 68" high x 24" deep (A chest of drawers can be set inside the closet, if desired.)
 - Measurement under the sink = 24" wide x 29" high x 28" deep
 - Residence Hall carpet measurements: Please see floor plan
 - Carpet may not be taped, glued, nailed, or affixed to the floor in any way.
- Residence Hall windows have mini blinds. There are no curtain rods. Please bring spring tension rods. (Curtains cannot be so long that they touch the heater vent.)
- If your son or daughter is a transfer student, they may be placed in a Residence Hall or possibly one of our townhouse style apartments (Each apartment houses six students and has three bedrooms, two bathrooms, small kitchenette, and living room.). Furniture is provided for apartments (beds, desk chairs, living room furniture, and one under-the-counter refrigerator).
- Apartment window size = 37 ¼" wide x 46" high